



# CX.250 110÷220V

## PNEUMATIC BRAKE WITH F90 COVER



- ✓ Modular brake
- ✓ Long life span
- ✓ Constant and precise torque control
- ✓ Minimum maintenance
- ✓ High heat dissipation
- ✓ Compact size
- ✓ Respect for the environment and operator's health
- ✓ Unique fan powered with a voltage from 110V to 240V

Since more than 40 years the Combiflex pneumatic brake has been representing the reference brake for the converting industry, today it's the best seller brake in the world.

All our Combiflex brakes are equipped with asbestos free pads to guarantee respect for the working environment and the operator's health; moreover, they are equipped with a single fan and a turbine disc that convey the air flow in the crucial zone of the brake increasing the life span, the heat dissipation and reducing the maintenance.



Combiflex is a modular brake, it means that we can provide it with a number of calipers required by the application; moreover, the distributors of each caliper can always be accessed in order to select the most suitable number of calipers for the regulation.

Combiflex brake guarantees long life span of the pads, constant and precise torque control, high heat dissipation and compact size.

The new F90 cover is equipped with a new and unique fan with very high performance. It can be easily powered with a voltage from 110V to 240V.

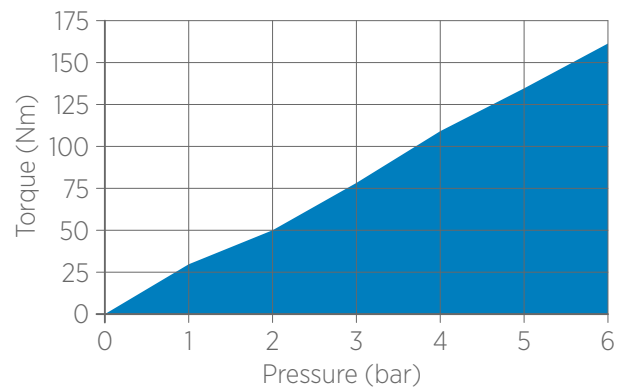
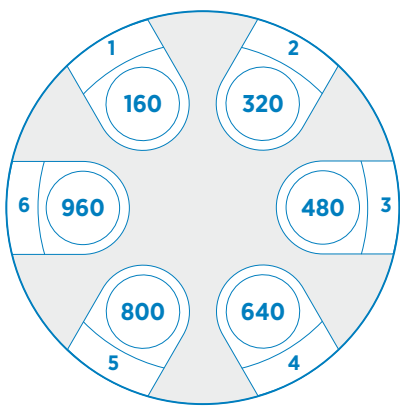
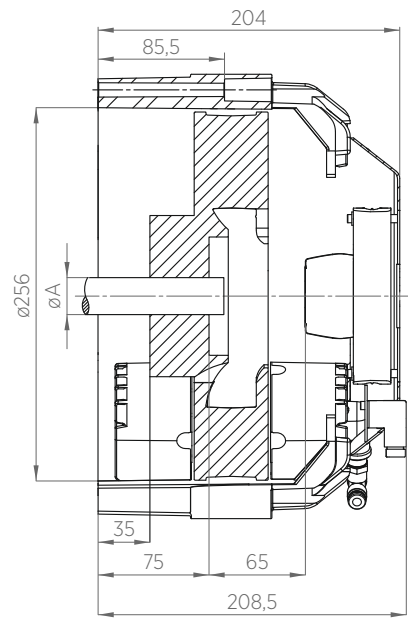
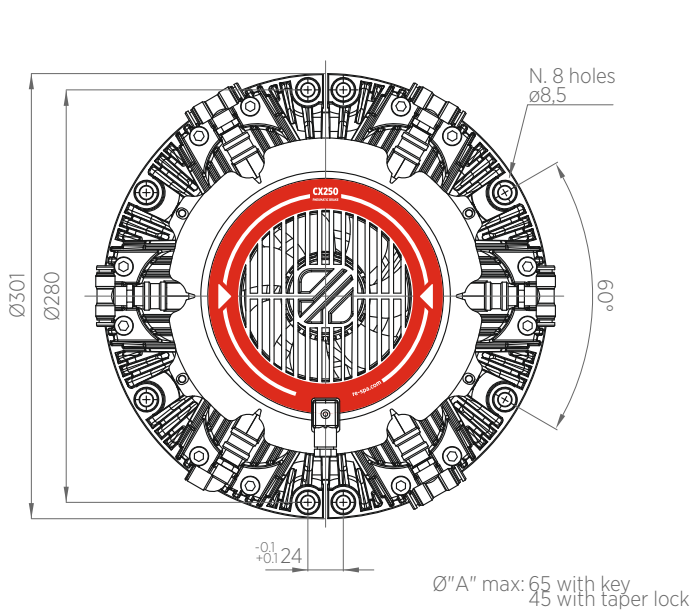
# TECHNICAL DRAWING



 N. of calipers  
 Torque in Nm relating n. of calipers

## TECHNICAL CHARACTERISTICS

Torque max 1 caliper	160 Nm
Torque min 1 caliper	1,5 Nm
Pressure min / max	0,3/6 bar
Max disc rpm	2500 rpm
Total weight	20 kg
Disc inertia	0,04 Kgm <sup>2</sup>
Heat dissipation with fan 110÷220V	3,5 kW

\*Data are subject to technical change without notice

\*\* Torque values relate to dynamic slipping



Re S.p.A.  
via Firenze 3  
20060 Bussero (MI) Italy

T +39 02 9524301  
F +39 02 95038986  
E [info@re-spa.com](mailto:info@re-spa.com)

Assistenza tecnica  
Technical support  
T +39 02 952430.300  
E [support@re-spa.com](mailto:support@re-spa.com)

Assistenza commerciale  
Sales support  
T +39 02 952430.200  
E [sales@re-spa.com](mailto:sales@re-spa.com)