

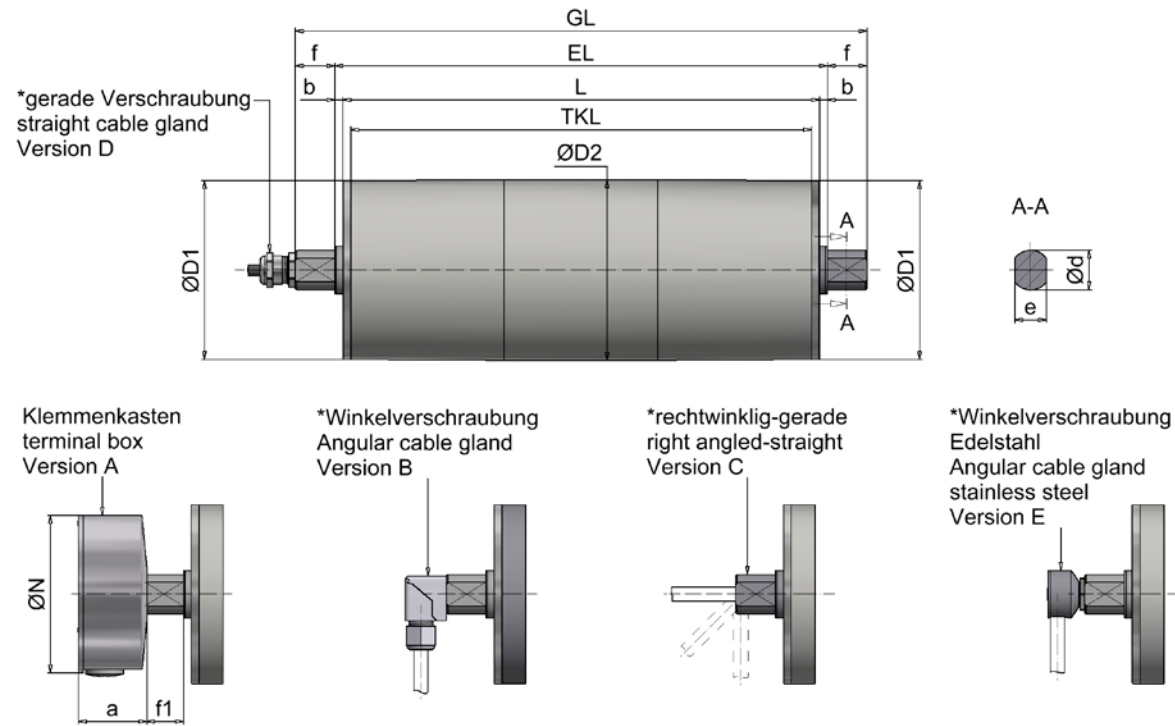

| MODEL SERIES TM113

MODEL SERIES TM113

Drum motor TM113, standard



Deflection drum UT113, standard

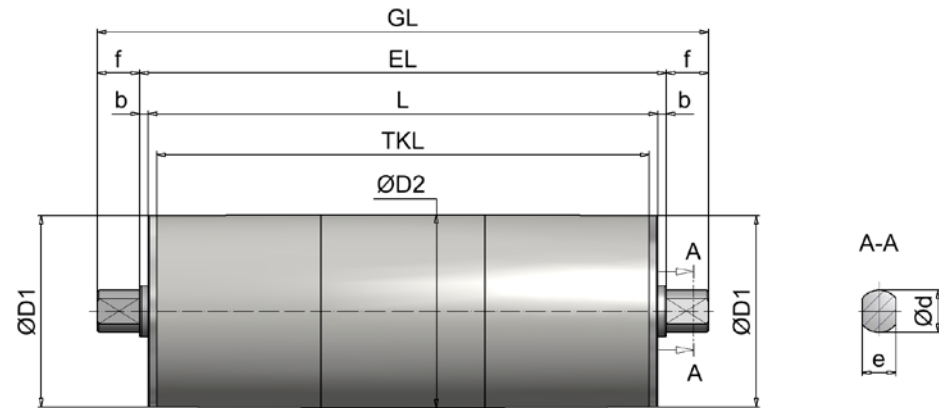

all dimensions in mm

HIMMEL® drum motor												
Size	Type	Ø D1**	Ø D2**	a	Ø N	Ø d	e	f	f1	TKL	b	EL
113	TM113.1	112,5	113,5	43	100	25	20	25	23	L - 10	5	L + 10

HIMMEL® deflection drum												
Size	Type	Ø D1**	Ø D2**	a	Ø N	Ø d	e	f	f1	TKL	b	EL
113	TM113.1	112,5	113,5			25	20	25		L - 10	5	L + 10

* with 3 m cable

** Diameter with cylindrical drum body 113

MODEL SERIES TM113

Overview of services

Type	Performance	Speed	Rotational speed	Belt tension	Drum torque	Power Consumption at 400 V / 50 Hz	Drum length L min.	Weight
	P2	v	n2	F	T2			
	[kW]	[m/s]	[1/min]	[N]	[Nm]	[A]	[mm]	[kg]
TM113.1	0,075 8-pole	0,09	16	795	45	0,45	IP66 260 IP67 260 IP69K 305	12,5
		0,12	19	650	37			
		0,14	23	541	31			
		0,16	28	456	26			
		0,19	33	388	22			
		0,23	38	333	19			
		0,26	44	286	16			
		0,28	47	271	15			
		0,34	57	221	13			
		0,41	68	184	10			
		0,48	81	155	9			
		0,57	95	132	8			
0,66	111	113	6					
0,77	129	98	6					
TM113.1	0,12 6-pole	0,14	23	876	50	0,57	IP66 260 IP67 260 IP69K 305	12,5
		0,17	28	716	41			
		0,20	34	596	34			
		0,24	40	503	29			
		0,28	47	428	24			
		0,33	55	367	21			
		0,38	64	316	18			
		0,40	68	299	17			
		0,49	83	244	14			
		0,59	99	203	12			
		0,70	118	171	10			
		0,82	138	146	8			
0,96	162	125	7					
1,11	188	108	6					
TM113.1	0,18 4-pole	0,21	36	845	48	0,68	IP66 260 IP67 260 IP69K 305	12,5
		0,26	44	690	39			
		0,31	53	575	33			
		0,37	63	485	27			
		0,44	73	413	23			
		0,51	86	354	20			
		0,59	99	304	17			
		0,63	105	288	16			
		0,76	129	235	13			
		0,92	155	196	11			
		1,09	183	165	9			
		1,28	215	141	8			
		1,49	251	121	7			
		1,73	292	104	6			

MODEL SERIES TM113



Performance data

Type	Performance	Speed	Rotational speed	Belt tension	Drum torque	Power consumption at 400 V / 50 Hz	Drum length L min.	Weight
	P2	v	n2	F	T2			L=400 mm
	[kW]	[m/s]	[1/min]	[N]	[Nm]			[A]
TM113.1	0,25 4-pole	0,21	36	1173	67	0,94	IP66 260 IP67 260 IP69K 305	12,5
		0,26	44	959	54			
		0,31	53	798	45			
		0,37	63	673	38			
		0,44	73	573	33			
		0,51	86	491	28			
		0,59	99	423	24			
		0,63	105	400	23			
		0,76	129	327	19			
		0,92	155	272	15			
		1,09	183	229	13			
		1,28	215	195	11			
		1,49	251	167	10			
		1,73	292	144	8			
TM113.1	0,30 4-pole	0,21	36	1408	80	1,10	IP66 280 IP67 280 IP69K 325	13,6
		0,26	44	1151	65			
		0,31	53	958	54			
		0,37	63	808	46			
		0,44	73	688	39			
		0,51	86	589	33			
		0,59	99	507	29			
		0,63	105	480	27			
		0,76	129	392	22			
		0,92	155	326	19			
		1,09	183	275	16			
		1,28	215	234	13			
		1,49	251	201	11			
		1,73	292	173	10			
TM113.1	0,37 2-pole	0,43	72	868	49	0,95	IP66 260 IP67 260 IP69K 305	12,5
		0,52	88	710	40			
		0,63	105	591	34			
		0,74	125	498	28			
		0,87	147	424	24			
		1,02	171	363	21			
		1,18	199	313	18			
		1,25	210	296	17			
		1,53	257	242	14			
		1,84	309	201	11			
		2,18	367	170	10			
		2,56	431	145	8			
		2,99	503	124	7			
		3,47	584	107	6			

MODEL SERIES TM113



Performance data

Type	Performance	Speed	Rotational speed	Belt tension	Drum torque	Power consumption at 400 V / 50 Hz	Drum length L min.	Weight
	P2	v	n2	F	T2			L=400 mm
	[kW]	[m/s]	[1/min]	[N]	[Nm]			[A]
TM113.1	0,55 2-pole	0,42	71	1300	74	1,26	IP66 280 IP67 280 IP69K 325	13,6
		0,52	87	1062	60			
		0,62	105	884	50			
		0,74	124	746	42			
		0,87	146	635	36			
		1,01	170	544	31			
		1,17	198	469	27			
		1,24	209	443	25			
		1,52	256	362	21			
		1,82	307	301	17			
		2,16	364	254	14			
		2,54	428	216	12			
		2,97	499	185	11			
		3,44	579	160	9			

- Deviating performance data and speeds on request
- Weight incl. oil filling (ready for operation)
- Additional weight: approx. 1 kg per 100 mm additional length
- The L min. dimension increases by 65 mm when the brakes are fitted

Standard widths [L] : 260, 280, 310, 360 ... 810 mm from 810 mm reinforced version.

MODEL SERIES TM113

Execution types and options

Standard version
<ul style="list-style-type: none"> spherically turned steel jacket, bright steel, coated with rust protection IP66 Aluminum bearing end caps Clamping spigot made of steel, coated with rust protection Spur gearbox with steel gearing (low-noise) Straight screw connection (incl. 3 m cable)

Options
<ul style="list-style-type: none"> Internal brake with terminal box Elbow fitting (with 3 m cable) Right-angled straight screw connection (with 3 m cable) Backstop (ball bearing freewheel) Sprocket/toothed belt pulley Sensor bearing unit (rotary encoder) Cylindrical drum body, rubberized, galvanized (customized) Stainless steel version Thermal contacts IP67 IP69K Suitable for frequency inverter operation for plastic modular belts and profile rubberizing Terminal box design in stainless steel Vertical installation possible (specify when ordering) Food oil HIMMEL® drum motor as built-in cartridge Single-phase alternating current motors on request cCSAus
Other versions available on request.

Clamping bearing for HIMMEL®-drum motor / HIMMEL® deflection drum type 113

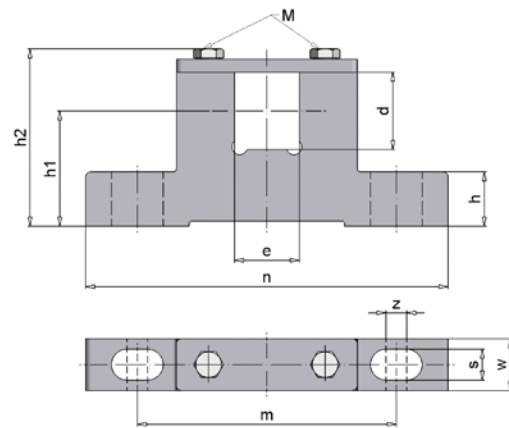

all dimensions in mm

Drum type	Clamping bearing	d	e	h	h1	h2	m	n	s	w	z	M	Material	approx. kg
TM113.1	EL25/20	25	20	21	44,5	66	100	140	12	20	8	M6	Steel	0,7

Color of the clamping bearings in RAL 7031

MODEL SERIES TM113

