

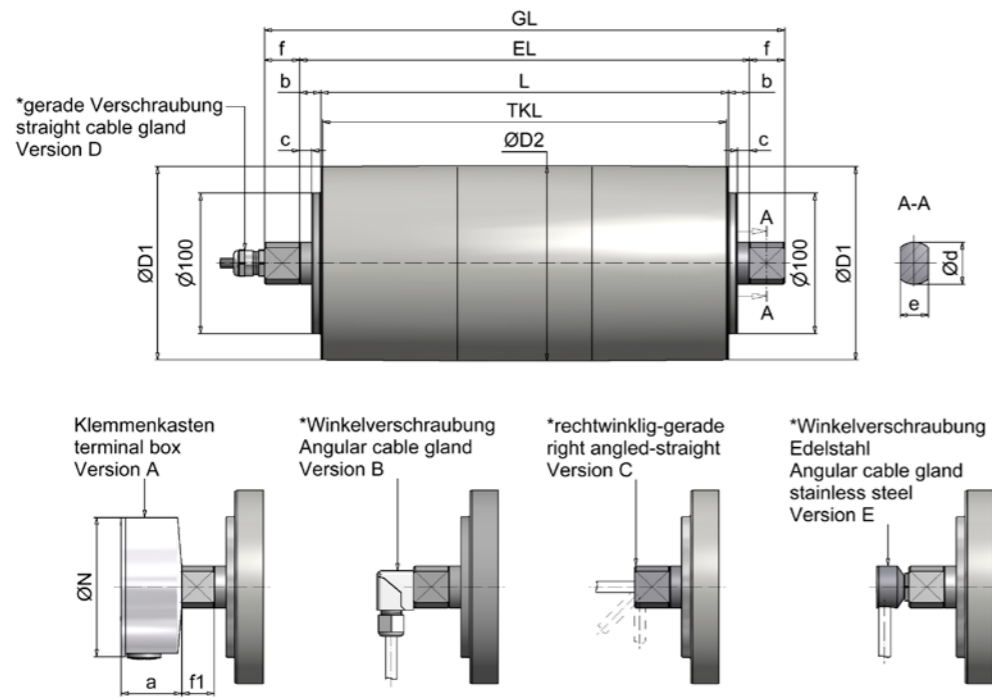

**| MODEL SERIES TM138**

# MODEL SERIES TM138

## Drum motor TM138, standard



## deflection drum UT138, standard

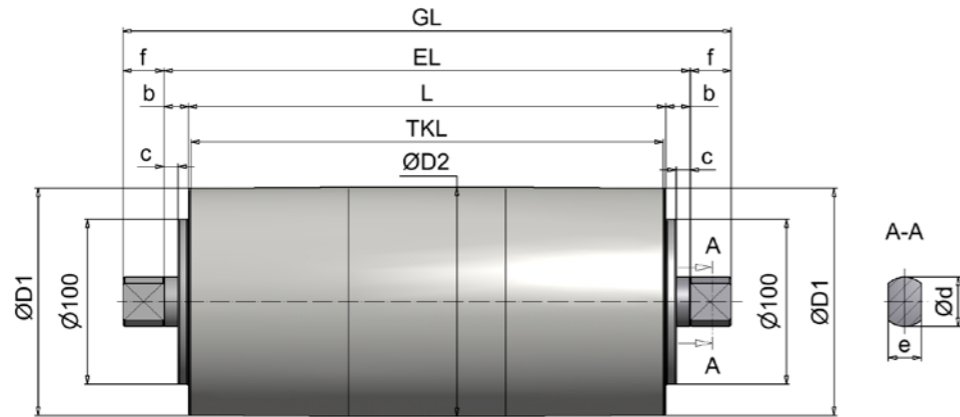

all dimensions in mm

HIMMEL® drum motor													
Size	Type	Ø D1	Ø D2**	a	Ø N	c	Ø d	e	f	f1	TKL	b	EL
138	TM138.1	137,5	139	43	100	8,5	30	20	25	23	L - 3	15	L + 30
HIMMEL® deflection drum													
138	UT138.1	137,5	139			8,5	30	20	25		L - 3	15	L + 30

\* with 3 m cable

\*\* Diameter with cylindrical drum body 138 mm

# MODEL SERIES TM138

## Overview of services

Type	Performance	Speed	Rotational speed	Belt tension	Drum torque	Power consumption at 400 V / 50 Hz	Drum length L min.	Weight	
	P2	v	n2	F	T2				L=400 mm
	[kW]	[m/s]	[1/min]	[N]	[Nm]				[A]
TM138.1	0,09 12-pole	0,04	6	2218	153	0,82	IP66 300 IP67 300 IP69K 320	15	
		0,05	7	1797	124				
		0,06	8	1478	102				
		0,07	9	1362	94				
		0,075	10	1198	83				
		0,08	11	1093	75				
		0,1	14	908	63				
		0,11	15	826	57				
		0,12	17	728	50				
		0,15	21	591	41				
		0,16	23	550	38				
		0,19	26	497	33				
TM138.1	0,18 8-pole	0,07	9	2739	189	0,80	IP66 300 IP67 300 IP69K 320	15	
		0,08	11	2219	153				
		0,1	14	1826	126				
		0,11	15	1683	116				
		0,12	17	1480	102				
		0,13	18	1350	93				
		0,16	22	1122	77				
		0,18	24	1020	70				
		0,2	28	900	62				
		0,25	34	731	50				
		0,26	37	680	47				
		0,3	42	592	41				
0,4	56	449	31						
0,5	69	360	25						
0,66	92	272	19						
TM138.1	0,25 6-pole	0,09	12	2782	192	0,85	IP66 300 IP67 300 IP69K 320	15	
		0,11	15	2254	156				
		0,13	19	1855	128				
		0,15	20	1709	118				
		0,17	23	1503	104				
		0,18	25	1371	95				
		0,22	30	1139	79				
		0,24	33	1036	71				
		0,27	38	914	63				
		0,34	47	742	51				
		0,36	50	691	48				
		0,42	58	601	41				
0,55	76	456	31						
0,68	95	366	25						
0,91	125	276	19						

# MODEL SERIES TM138



## Overview of services

Type	Performance	Speed	Rotational speed	Belt tension	Drum torque	Power consumption at 400 V / 50 Hz	Drum length L min.	Weight
	P2	v	n2	F	T2			L=400 mm
	[kW]	[m/s]	[1/min]	[N]	[Nm]			[A]
TM138.1	0,25 4-pole	0,14	19	1848	128	0,80	IP66 300 IP67 300 IP69K 320	15
		0,17	23	1497	103			
		0,2	28	1232	85			
		0,22	30	1135	78			
		0,25	35	998	69			
		0,27	38	911	63			
		0,33	46	757	52			
		0,35	50	688	47			
		0,41	57	607	42			
		0,51	70	493	34			
		0,55	75	459	32			
		0,63	87	399	28			
		0,83	114	303	21			
		1,03	143	243	17			
1,36	189	183	13					
TM138.1	0,37 4-pole	0,14	19	2735	189	1,10	IP66 300 IP67 300 IP69K 320	15
		0,17	23	2216	153			
		0,2	28	1823	126			
		0,22	30	1680	116			
		0,25	35	1477	102			
		0,27	38	1348	93			
		0,33	46	1120	77			
		0,36	50	1018	70			
		0,41	57	898	62			
		0,51	70	729	50			
		0,55	75	679	47			
		0,63	87	591	41			
		0,83	114	448	31			
		1,03	143	359	25			
1,36	189	271	19					
TM138.1	0,55 4-pole	0,2	28	2740	189	1,60	IP66 300 IP67 300 IP69K 320	15
		0,22	30	2525	174			
		0,25	34	2220	153			
		0,27	38	2025	140			
		0,33	45	1683	116			
		0,36	50	1530	106			
		0,41	56	1350	93			
		0,5	69	1096	76			
		0,54	75	1020	70			
		0,62	86	888	61			
		0,82	113	673	46			
		1,02	141	540	37			
		1,35	187	408	28			

# MODEL SERIES TM138



## Overview of services

Type	Performance	Speed	Rotational speed	Belt tension	Drum torque	Power consumption at 400 V / 50 Hz	Drum length L min.	Weight
	P2	v	n2	F	T2			L=400 mm
	[kW]	[m/s]	[1/min]	[N]	[Nm]			[A]
TM138.1	0,75 4-pole	0,32	44	2338	161	2,20	IP66 300 IP67 300 IP69K 320	15
		0,35	49	2125	147			
		0,4	55	1875	129			
		0,49	68	1522	105			
		0,53	73	1417	98			
		0,61	84	1233	85			
		0,8	111	935	65			
		1	138	750	52			
		1,32	183	566	39			
		TM138.1	0,75 2-pole	0,27	37			
0,33	46			2270	157			
0,4	56			1868	129			
0,44	60			1721	119			
0,5	69			1513	104			
0,54	75			1381	95			
0,65	90			1148	79			
0,72	99			1043	72			
0,81	113			920	64			
1	139			747	52			
1,08	149			696	48			
1,24	171			605	42			
1,63	226			459	32			
2,04	282			368	25			
2,7	373	278	19					
TM138.1	0,90 2-pole	0,33	46	2695	186	1,95	IP66 300 IP67 300 IP69K 320	15
		0,41	56	2218	153			
		0,44	61	2044	141			
		0,5	69	1797	124			
		0,55	76	1639	113			
		0,66	91	1362	94			
		0,73	101	1239	85			
		0,82	114	1093	75			
		1,01	140	887	61			
		1,09	151	826	57			
		1,25	173	719	50			
		1,65	229	545	38			
		2,06	285	437	30			
2,73	377	330	23					

# MODEL SERIES TM138

## Overview of services

Type	Performance	Speed	Rotational speed	Belt tension	Drum torque	Power consumption at 400 V / 50 Hz	Drum length L min.	Weight
	P <sub>2</sub>	v	n <sub>2</sub>	F	T <sub>2</sub>			L=400 mm
	[kW]	[m/s]	[1/min]	[N]	[Nm]			[kg]
TM138.1	1,00 4-pole	0,4	56	2241	155	2,6	IP66 360 IP67 360 IP69K 390	15
		0,49	68	1820	126			
		0,53	74	1694	117			
		0,61	85	1474	102			
		0,81	111	1118	77			
		1	139	897	62			
		1,33	184	677	47			

- Deviating performance data and speeds on request
- Weight incl. oil filling (ready for operation)
- Additional weight: approx. 2 kg per 100 mm additional length
- The L min. dimension increases by 100 mm for brake attachment

Standard widths [L] : 300, 350, 400 ... 1000 mm from 1000 mm reinforced version.

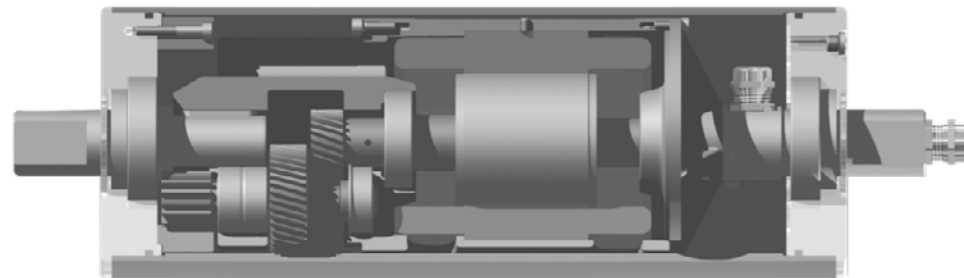

# MODEL SERIES TM138

## Execution types and options

Standard version	Optionen
<ul style="list-style-type: none"> <li>• Spherically turned steel jacket, bright steel, coated with rust protection</li> <li>• IP66</li> <li>• Aluminum bearing end caps</li> <li>• Clamping spigot made of steel, coated with rust protection</li> <li>• Spur gearbox with steel gearing (low-noise)</li> <li>• Straight screw connection (incl. 3 m cable)</li> </ul>	<ul style="list-style-type: none"> <li>• Internal brake</li> <li>• with terminal box</li> <li>• Elbow fitting (with 3 m cable)</li> <li>• Stainless steel elbow fitting (with 3 m cable)</li> <li>• Right-angled straight screw connection (with 3 m cable)</li> <li>• Backstop (ball bearing freewheel)</li> <li>• Sprocket/toothed belt pulley</li> <li>• Sensor bearing unit (rotary encoder)</li> <li>• Cylindrical drum body, rubberized, galvanized (customized)</li> <li>• Stainless steel version</li> <li>• Thermal contacts</li> <li>• IP67</li> <li>• IP69K</li> <li>• Suitable for frequency inverter operation</li> <li>• for plastic modular belts and profile rubberizing</li> <li>• Terminal box design in stainless steel</li> <li>• Vertical installation possible (specify when ordering)</li> <li>• Food oil</li> <li>• Single-phase AC motors on request</li> <li>• cCSAus</li> </ul>
	Other versions available on request.

## Clamping bearing for HIMMEL®-drum motor / HIMMEL® deflection drum type 138

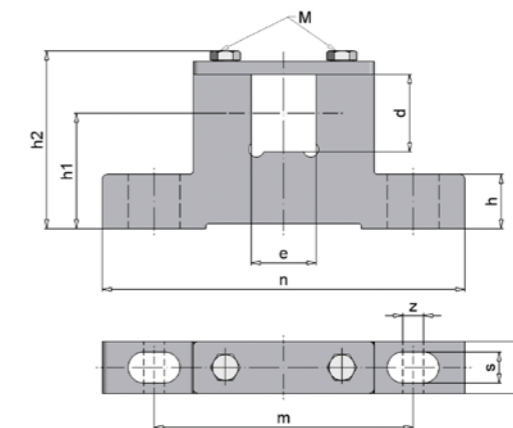

all dimensions in mm

Drum type	Clamping bearing	d	e	h	h1	h2	m	n	s	w	z	M	Material	approx. kg
TM138.1	EL30/20	30	20	21	44,5	68,5	100	140	12	24	8	M6	Steel	0,7

Color of the clamping bearings in RAL 7031