

| MODEL SERIES TM165

MODEL SERIES TM165

Drum motor TM165, standard

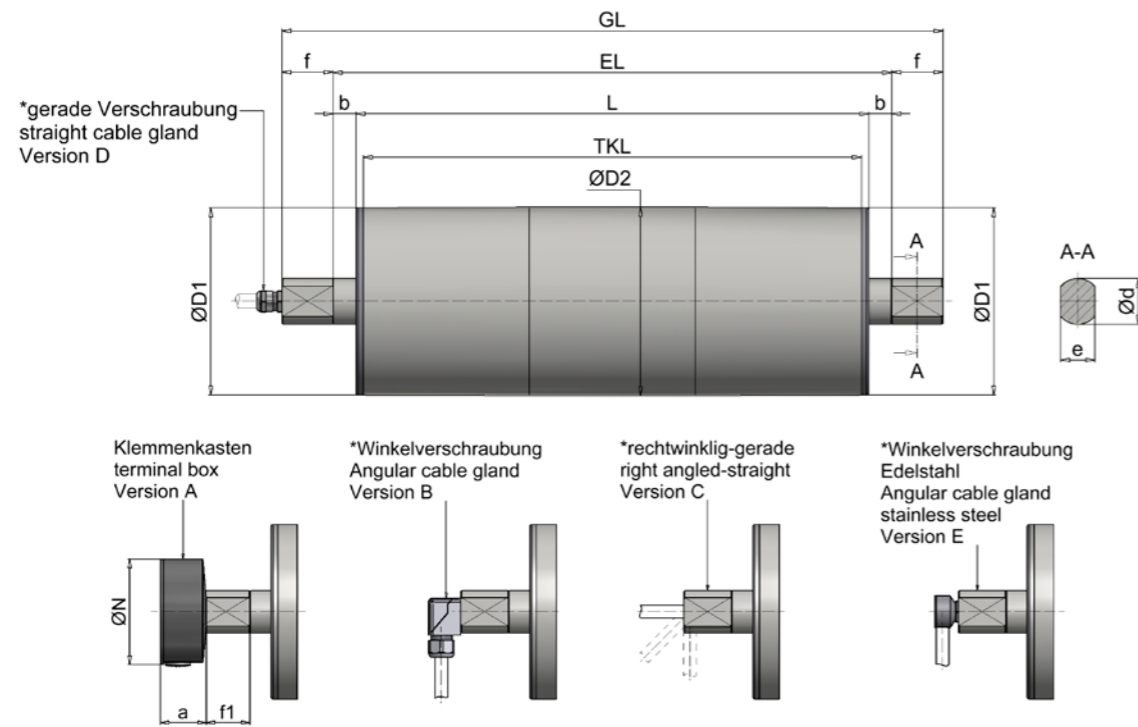

Deflection drum UT165, standard

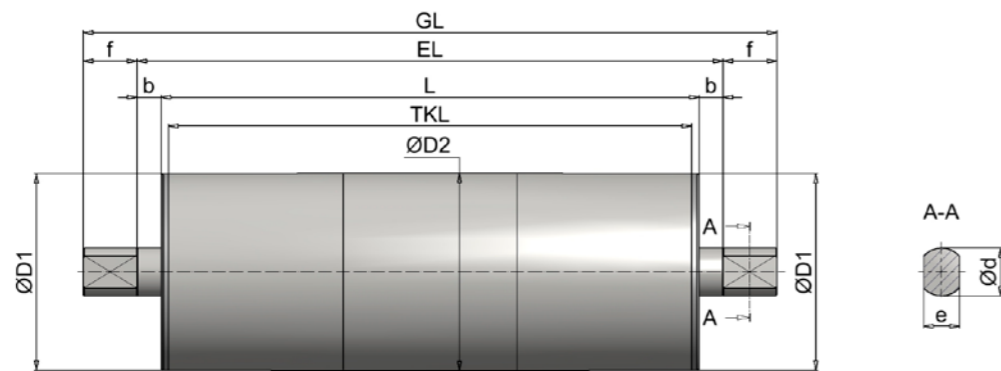

all dimensions in mm

HIMMEL® drum motor												
Size	Type	Ø D1	Ø D2**	a	Ø N	Ø d	e	f	f1	TKL	b	EL
165	TM165.1	164	165	43	100	40	30	45	43	L - 13	20	L + 40
HIMMEL® deflection drum												
165	UT165.1	164	165			40	30	45		L - 13	20	L + 40

* with 3 m cable

** Diameter with cylindrical drum body

MODEL SERIES TM165

Overview of services

Type	Performance	Speed	Rotational speed	Belt tension	Drum torque	Power consumption at 400 V / 50 Hz	Drum length L min.	Weight
	P2	v	n2	F	T2			
	[kW]	[m/s]	[1/min]	[N]	[Nm]	[A]	[mm]	[kg]
TM165.1	0,37 8-pole	0,19	22	1911	158	1,50	IP66 400 IP67 400 IP69K 450	44,0
		0,24	27	1573	130			
		0,28	33	1315	108			
		0,33	39	1111	92			
		0,39	45	946	78			
		0,46	53	810	67			
		0,54	63	682	56			
		0,66	76	562	46			
		0,79	91	470	39			
		0,93	108	397	33			
1,09	127	338	28					
1,28	148	289	24					
TM165.1	0,75 6-pole	0,25	29	2947	243	2,20	IP66 400 IP67 400 IP69K 450	44,0
		0,31	36	2427	200			
		0,37	43	2028	167			
		0,44	51	1714	141			
		0,51	59	1460	120			
		0,60	69	1249	103			
		0,71	82	1053	87			
		0,87	100	867	71			
		1,04	120	724	60			
		1,23	142	612	51			
1,44	167	521	43					
1,68	195	446	37					
TM165.1	1,10 4-pole	0,39	45	2841	234	3,00	IP66 400 IP67 400 IP69K 450	44,0
		0,47	54	2339	193			
		0,56	65	1955	161			
		0,67	77	1652	136			
		0,78	91	1407	116			
		0,91	106	1204	99			
		1,08	126	1014	84			
		1,32	152	835	69			
		1,58	182	698	58			
		1,86	216	590	49			
2,19	253	502	41					
2,56	296	430	35					
TM165.1	1,50 4-pole	0,56	65	2656	219	3,60	IP66 425 IP67 425 IP69K 475	47,0
		0,67	77	2245	185			
		0,78	91	1911	158			
		0,92	106	1636	135			
		1,09	126	1378	114			
		1,32	153	1135	94			
		1,58	183	949	78			
		1,87	217	802	66			
		2,20	254	683	56			
		2,57	297	584	48			

MODEL SERIES TM165

Overview of services

Type	Performance	Speed	Rotational speed	Belt tension	Drum torque	Power consumption at 400 V / 50 Hz	Drum length L min.	Weight
	P2	v	n2	F	T2			
	[kW]	[m/s]	[1/min]	[N]	[Nm]			[A]
TM165.1	2,20 2-pole	0,78	91	2805	231	4,30	IP66 425 IP67 425 IP69K 475	47,0
		0,95	110	2310	191			
		1,14	132	1931	159			
		1,35	156	1632	135			
		1,58	183	1389	115			
		1,85	214	1189	98			
		2,20	254	1002	83			
		2,67	309	825	68			
		3,19	369	690	57			
		3,78	437	583	48			
TM165.1	3,00 2-pole	1,10	127	2561	212	6,80	IP66 470 IP67 470 IP69K 500	48,0
		1,30	151	2163	179			
		1,53	177	1843	152			
		1,79	207	1577	130			
		2,12	246	1357	112			
		2,58	300	1117	93			
		3,08	357	934	78			
		3,65	423	789	66			
		4,28	496	672	56			
		5,01	580	575	48			

- Deviating performance data and speeds on request
- Weight incl. oil filling (ready for operation)
- Additional weight: approx. 3 kg for 100 mm additional length
- With brake attachment, the L min. dimension increases by 110 mm

Standard widths [L] : 400, 425, 450, 500 ... 1300 mm from 1300 mm reinforced version.



Drum motors in mobile conveyor systems

MODEL SERIES TM165

Execution types and options

Standard version	Options
<ul style="list-style-type: none"> • Spherically turned steel jacket, bright steel, coated with rust protection • IP66 • Aluminum bearing end caps • Clamping spigot made of steel, coated with rust protection • Spur gearbox with steel gearing (low-noise) • Straight screw connection (incl. 3m cable) 	<ul style="list-style-type: none"> • Internal brake • With terminal box • Elbow fitting (with 3 m cable) • Stainless steel elbow fitting (with 3 m cable) • Right-angled straight screw connection (with 3 m cable) • Backstop (ball bearing freewheel) • Sprocket/toothed belt pulley • Sensor bearing unit (rotary encoder) • Cylindrical drum body, rubberized, galvanized (customized) • Stainless steel version • Thermal contacts • IP67 • IP69K • Suitable for frequency inverter operation • for plastic modular belts and profile rubberizing • Terminal box design in stainless steel • Vertical installation possible (specify when ordering) • Food oil • Single-phase AC motors on request • cCSAus
	Other versions available on request.

Clamping bearing for HIMMEL®-drum motor / HIMMEL® deflection drum type 165

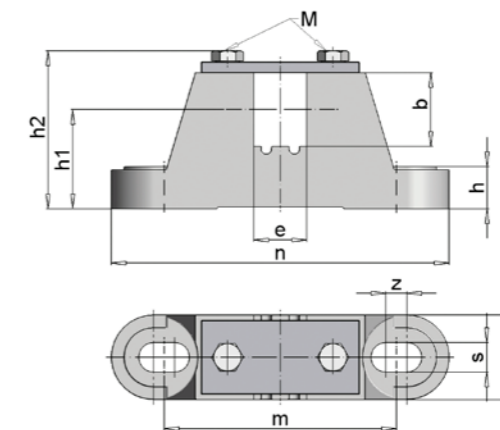

all dimensions in mm

Drum type	Clamping bearing	d	e	h	h1	h2	m	n	s	w	z	M	Material	approx. kg
TM/UT165.1	EL40/30 A	40	30	20	47	78,5	110	160	14	40	10	M8	Cast iron	1,5

Color of the clamping bearings in RAL 7031