

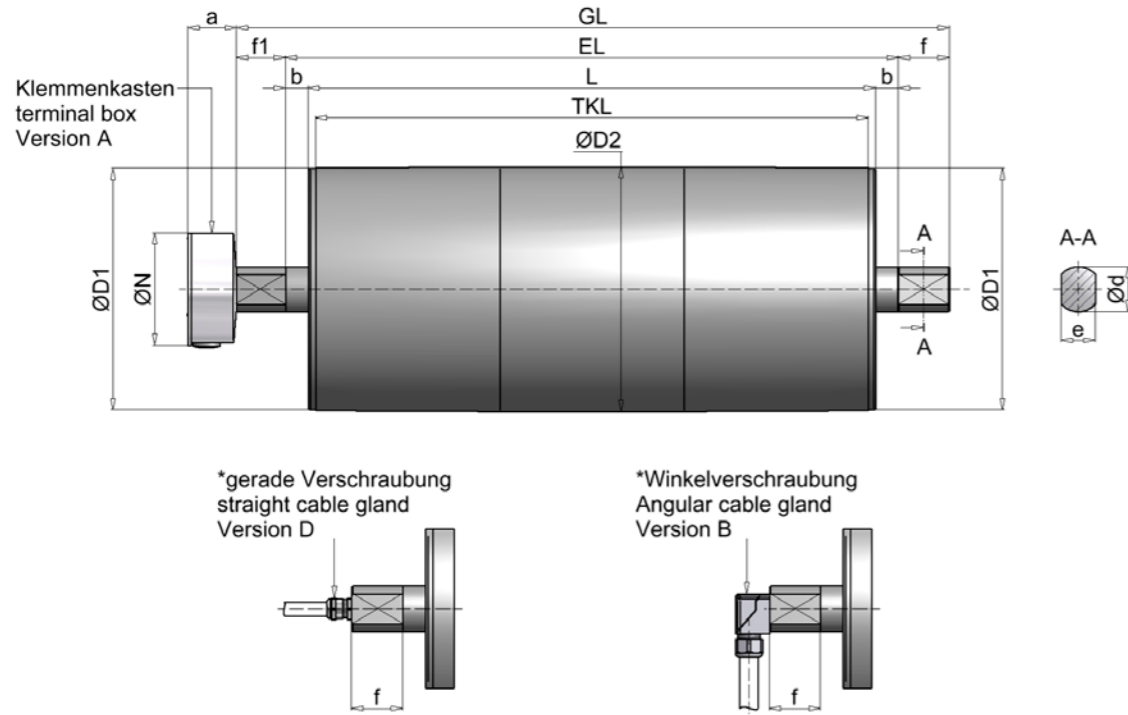

| MODEL SERIES TM216

MODEL SERIES TM216

Drum motor TM216.0, standard



Deflection drum UT165, standard

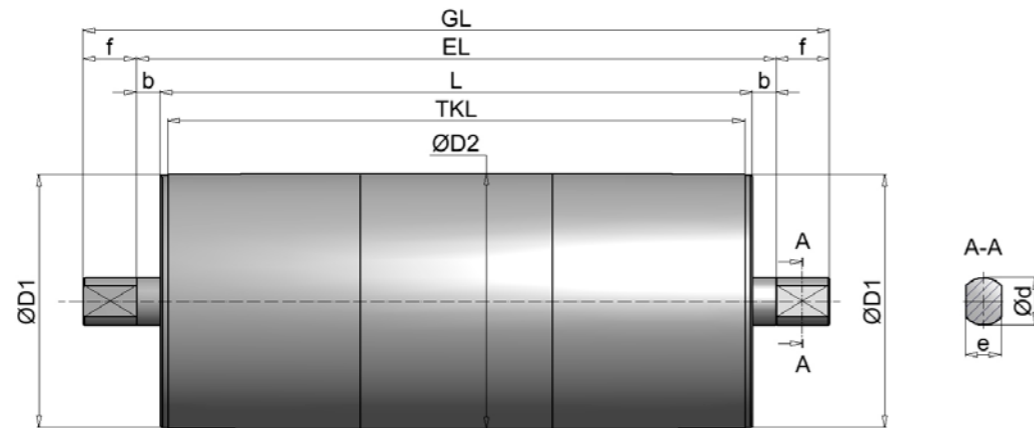

all dimensions in mm

HIMMEL® drum motor													
Size	Type	Ø D1	Ø D2**	a	Ø N	c	Ø d	e	f	f1	TKL	b	EL
216	TM216.0	213,5	216	43	100		40	30	45	45	L - 13	20	L + 40

HIMMEL® deflection drum													
Size	Type	Ø D1	Ø D2**	a	Ø N	c	Ø d	e	f	f1	TKL	b	EL
216	UT216.0	213,5	216				40	30	45		L - 13	20	L + 40

* with 3 m cable

** Diameter with cylindrical drum body

MODEL SERIES TM216

Drum motor TM216.1, standard

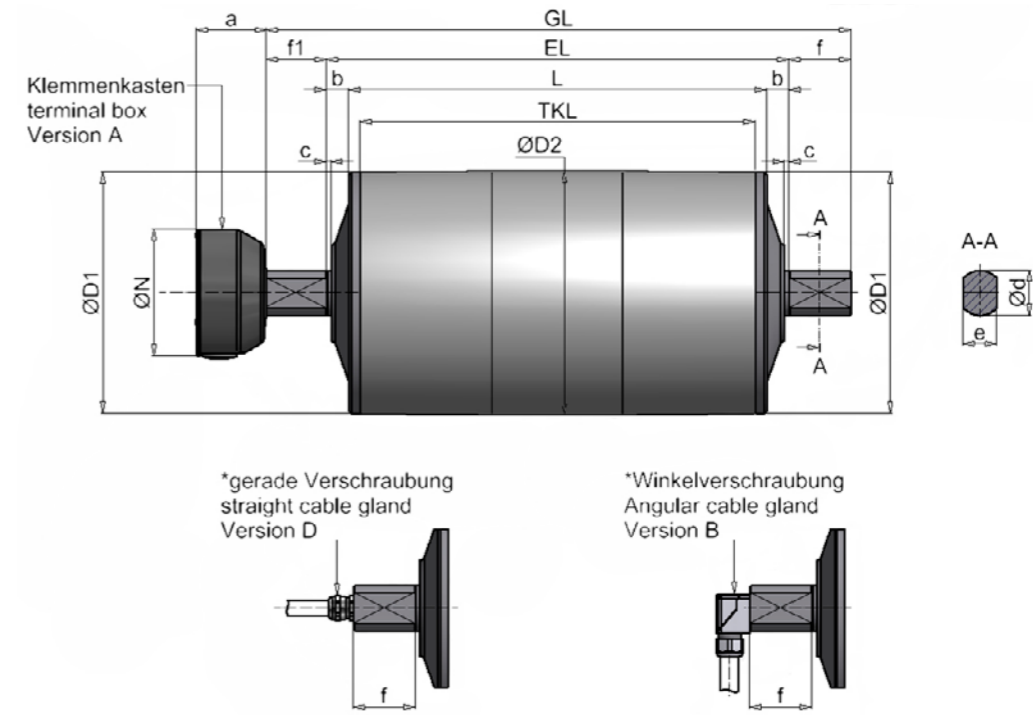

Deflection drum UT216.1, standard

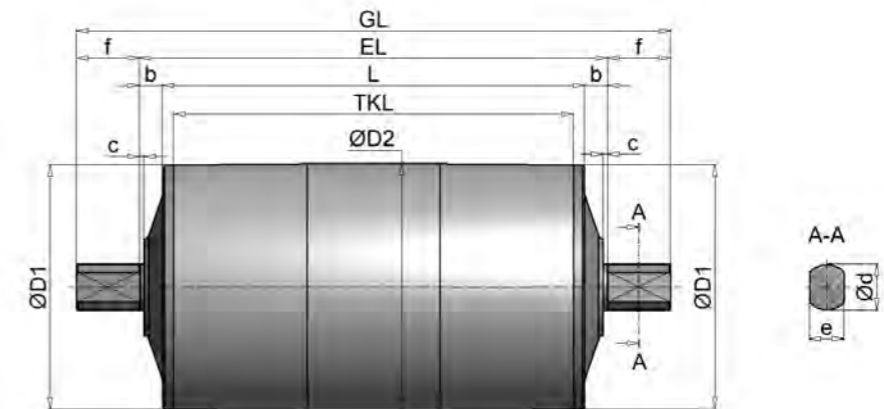

all dimensions in mm

HIMMEL® drum motor												Standard IP65		optional IP66		optional IP67	
Size	Type	Ø D1	Ø D2**	a	Ø N	c	Ø d	e	f	f1	TKL	b	EL	b	EL	b	EL
216	TM216.1	213,5	216	62	112	4	40	30	55	53	L - 20	20	L + 40	20	L + 40	37	L + 74

HIMMEL® deflection drum																		
Size	Type	Ø D1	Ø D2**	a	Ø N	c	Ø d	e	f	f1	TKL	b	EL	b	EL	b	EL	
216	UT216.1	213,5	216				4	40	30	55		L - 20	20	L + 40	20	L + 40	37	L + 74

* with 3 m cable

** Diameter with cylindrical drum body

MODEL SERIES TM216

Overview of services type TM216.0-TM216.1

Type	Performance	Speed	Rotational speed	Belt tension	Drum torque	Power consumption at 400 V / 50 Hz	Drum length L min.	Weight				
	P2	v	n2	F	T2			L=500 mm				
	[kW]	[m/s]	[1/min]	[N]	[Nm]			[A]	[mm]	[kg]		
TM216.0	0,37 8-pole	0,25	22	1460	158	1,50	400	50				
		0,31	27	1202	130							
		0,37	33	1005	108							
		0,44	39	849	92							
		0,51	45	723	78							
		0,60	53	619	67							
		0,71	63	521	56							
		0,86	76	429	46							
		1,03	91	359	39							
		1,22	108	303	33							
TM216.0	0,75 6-pole	0,33	29	2251	243	2,20	400	50				
		0,40	36	1854	200							
		0,48	43	1549	167							
		0,57	51	1309	141							
		0,67	59	1115	120							
		0,79	69	954	103							
		0,93	82	804	87							
		1,13	100	662	71							
		1,36	120	553	60							
		1,60	142	468	51							
TM216.1	1,50 4-pole	0,33	29	4604	497	3,20	420	57,0				
		0,37	33	4016	434							
		0,48	42	3134	338							
		0,60	53	2504	270							
		TM216.1	2,20 4-pole	0,47	42			4679	505	4,80	420	59,0
				0,59	52			3738	404			
				0,84	75			2610	282			
				1,15	102			1909	206			
TM216.1	3,00 4-pole	0,85	75	3547	383	6,60	450	57,0				
		1,16	102	2594	280							
		1,33	117	2263	244							
		1,70	150	1766	191							
		2,13	188	1411	152							

- Deviating performance data and speeds on request
- Weight incl. oil filling (ready for operation)
- Additional weight: approx. 5 kg per 100 mm additional length
- With brake attachment, the L min. dimension increases by 110 mm

Standard widths [L] : 400, 425, 450, 500 ... 1350 mm from 1350 mm reinforced version.

MODEL SERIES TM216

Execution types and options

Standard version	Options
<ul style="list-style-type: none"> • Spherically turned steel jacket, bright steel, coated with rust protection • IP66 with TM216.0 • IP65 with TM216.1 • 216.0 – Aluminum bearing end caps • 216.1 – Bearing end cover made of gray cast iron, painted to RAL 7031 • Clamping spigot made of steel, coated with rust protection • Spur gearbox with steel gearing (low-noise) • Terminal box 	<ul style="list-style-type: none"> • Internal brake • Elbow fitting (with 3 m cable) • Straight screw connection (incl. 3 m cable) • Backstop (ball bearing freewheel) • Sprocket/toothed belt pulley • Sensor bearing unit (rotary encoder) • Cylindrical drum body, rubberized, galvanized • (customized) • Stainless steel version • Thermal contacts • IP66 • IP67 • Suitable for frequency inverter operation • Terminal box design in stainless steel • Vertical installation possible (specify when ordering) • Food oil <p>Other versions available on request.</p>

Clamping bearing for HIMMEL®-drum motor / HIMMEL® deflection drum type 216

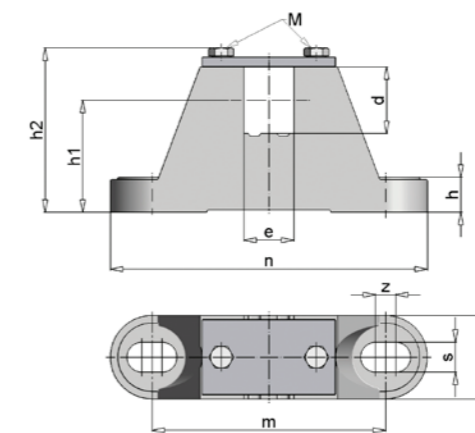

all dimensions in mm

Drum type	Clamping bearing	d	e	h	h1	h2	m	n	s	w	z	M	Material	approx. kg
TM/UT216.0	EL40/30 A	40	30	20	47	76	110	160	14	40	10	M8	Cast iron	1,5
TM/UT216.1	EL40/30 B	40	30	21	67	102,5	140	190	18	50	12	M8		2,8

Color of the clamping bearings in RAL 7031