

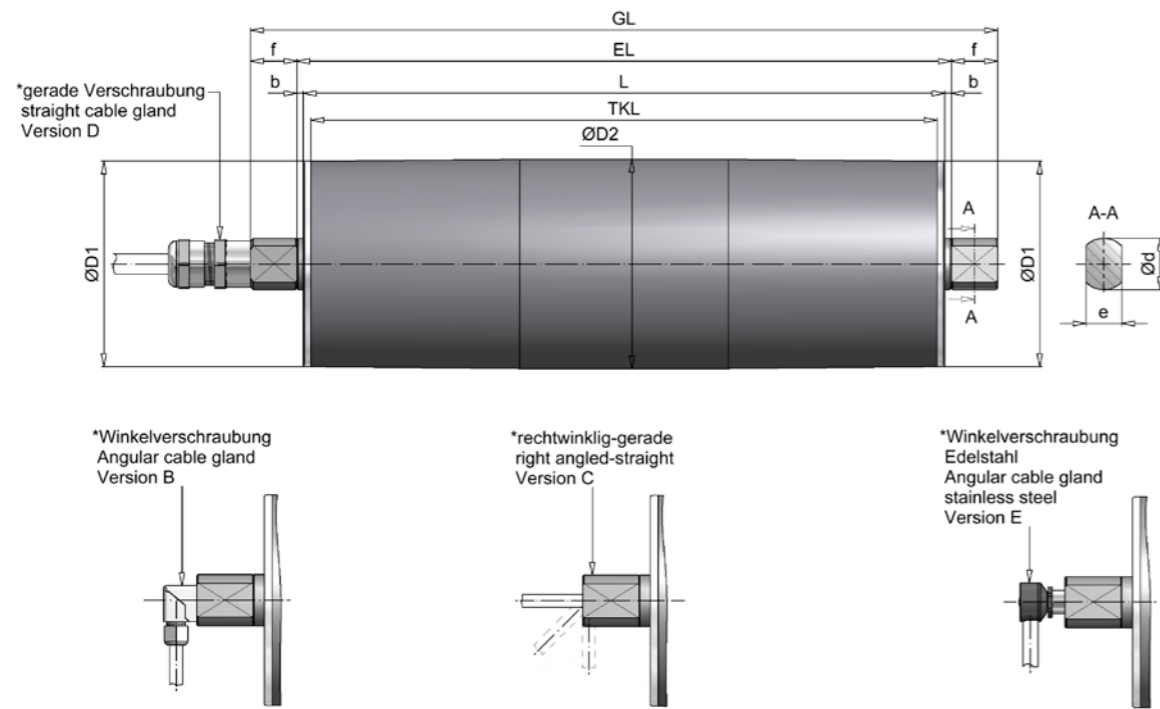

| MODEL SERIES TM82

MODEL SERIES TM82

Drum motor TM82, standard



deflection drum UT82, standard

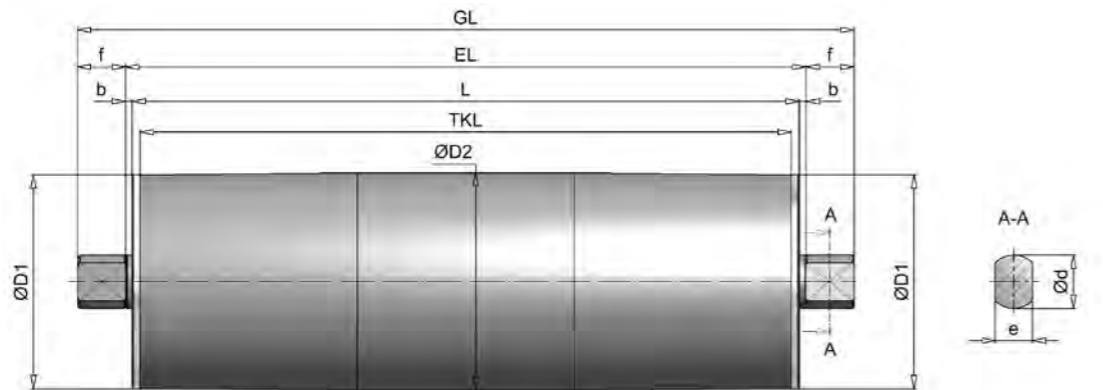

all dimensions in mm

HIMMEL® drum motor												
Size	Type	Ø D1**	Ø D2**	a	Ø N	Ø d	e	f	f1	TKL	b	EL
82	TM82.1	80	81,5			20	14	18		L - 6	2,5	L + 5

HIMMEL® deflection drum												
Size	Type	Ø D1**	Ø D2**	a	Ø N	Ø d	e	f	f1	TKL	b	EL
82	UT82.1	80	81,5			20	14	18		L - 6	2,5	L + 5

* with 3 m cable

** Diameter with cylindrical drum body Ø 81 mm

MODEL SERIES TM82

Overview of services

Type	Performance	Speed	Rotational speed	Belt tension	Drum torque	Power consumption at 400 V / 50 Hz	Drum length L min.	Weight
	[kW]	[m/s]	[1/min]	[N]	[Nm]			
TM82.1	0,018 8-pole	0,03	8	537	22	0,18	IP66 250 IP67 250 IP69K 280	4,5
		0,05	11	375	15			
		0,06	14	305	12			
		0,09	20	209	9			
		0,12	29	146	6			
TM82.1	0,04 4-pole	0,15	36	119	5	0,23	IP66 200 IP67 200 IP69K 240	3,5
		0,08	19	482	20			
		0,10	22	419	17			
		0,14	32	292	12			
		0,17	39	238	10			
		0,25	58	163	7			
TM82.1	0,07 2-pole	0,35	83	114	5	0,20	IP66 200 IP67 200 IP69K 240	3,5
		0,43	101	93	4			
		0,18	43	384	16			
		0,21	49	334	14			
		0,30	70	233	9			
		0,37	87	190	8			
TM82.1	0,07 4-pole	0,54	126	130	5	0,37	IP66 250 IP67 250 IP69K 280	4,5
		0,77	181	91	4			
		0,95	222	74	3			
		0,08	20	827	34			
		0,10	23	718	29			
		0,14	33	501	20			
TM82.1	0,12 2-pole	0,17	40	408	17	0,31	IP66 250 IP67 250 IP69K 280	4,5
		0,25	59	279	11			
		0,36	84	195	8			
		0,44	103	159	6			
		0,19	43	647	26			
		0,21	50	562	23			
		0,31	72	392	16			
0,38	88	319	13					
0,55	129	218	9					
0,79	185	152	6					
0,97	227	124	5					

- Deviating performance data and speeds on request
- Weight incl. oil filling (ready for operation)
- Additional weight: approx. 0.8 kg for 100 mm additional length
- The L min. dimension increases by 100 mm when the brakes are fitted

Standard widths [L] : 200, 250, 300, 350 ... 800 mm, above 800 mm please contact us

MODEL SERIES TM82

Execution types and options

Standard version	Options
<ul style="list-style-type: none"> spherically turned steel jacket, bright steel, coated with rust protection IP66 Aluminum bearing end caps Clamping spigot made of steel, coated with rust protection Spur gearbox with steel gearing (low-noise) Straight screw connection (incl. 3 m cable) 	<ul style="list-style-type: none"> Internal brake Elbow fitting (with 3 m cable) Stainless steel elbow fitting (with 3 m cable) Right-angled straight screw connection (with 3 m cable) Backstop (ball bearing freewheel) Sprocket/toothed belt pulley Sensor bearing unit (rotary encoder) Cylindrical drum body, rubberized, galvanized (customer-specific) Stainless steel version Thermal contacts IP67 IP69K Suitable for frequency inverter operation for plastic modular belts and profile rubberizing Vertical installation possible (specify when ordering) Food oil HIMMEL® drum motor as built-in cartridge Single-phase alternating current motors on request cCSAus
	Other versions available on request.

Clamping bearing for HIMMEL®-drum motor / HIMMEL® deflection drum type 82

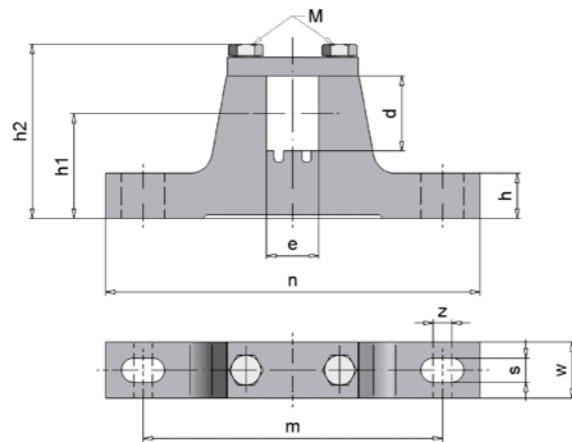

all dimensions in mm

Drum type	Clamping bearing	d	e	h	h1	h2	m	n	s	w	z	M	Material	approx. kg
TM/UT82.1	EL20/14	20	14	12	28	47	80	100	6,5	15	5	M5	Steel	0,25

Color of the clamping bearings in RAL 7031

MODEL SERIES TM82

